

Dear Collector and Model Builder,

If you are reading this, you are holding the BEST B-wing kit On the Market! I know you will find it was worth the wait and will make an amazing display piece for your collection.

On Behalf of Morten and myself, we would like to Thank you for purchasing this kit and for your patience. We know the kit has been a long awaited one but we have done our best to bring you a kit that you will enjoy building.

Our kit is neither one of the Studio Scale versions due major differences between the two models build. But we have done our best to make A nice B-wing which can be made to each model with some work on your part. We call them the BLUE and ORANGE.

Over the years, we have seen and built many kits that frankly required more work than they were worth.

While our kit is not without flaws, we have done our best to recreate the model as close to the Studio Scale versions as we could. We did our best to eliminate all bubbles and provide quality castings. It still is a KIT and will require some work on your part.

Problem areas are the cockpit interior assembly, upper and lower guns, engine fuselage and mounting.

Despite pressure casting, you may find small bubble holes that will need to be filled or fits that need putty and sanding. We recommend sandable epoxy putty to fill and BONDOL PUT putty.

The small parts are very fragile be careful removing them from the fill sprue. Lost detail can also be replaced with putty such as MAGIC SCULPT.
(<http://www.magicsculpt.com/>).

Attention to the reference material and instructions is CRITICAL!!! Certain parts go in a certain way based on their shape. Some things need to be painted first.

Take your time and please do not hesitate to email us with any questions as any of us are here and happy to help.

More reference can be found at:

<http://www.modelermagic.com>

<http://www.flickr.com/photos/toromodel/tags/b>

You can reach any of us on at
FMMODELCO@yahoo.com

Thanks again, and Happy Modeling!

FM Model Co.
Frank Cerney and Morten Moeslund

Before you begin:

- Clean all model parts with a strong cleaner in order to remove any mold release.

- Remove any sprue or flash

- Test fit all parts together before gluing into place

- A Cyanoacrylate glue (super glue) should be used in attaching parts. Regular model glue will not work

- Mold seams should be sanded and imperfections filled with modeling putty. Part seams (created when two parts are joined together) may be filled with putty

- Warped parts - use a hand held hair dryer to soften/relax the area. Adjust the part and cool it with cool water. Once cool, the part should retain it's shape.

- Prime model before final painting with a thin coat of primer and lightly sand with 400 grit sandpaper.



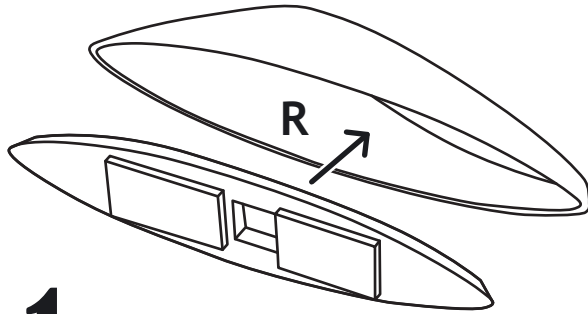

1 Left and Right side PODS

Attach the two bottoms to each POD and putty the seams and sand.



The Orange B has a panel removed on of the pods.

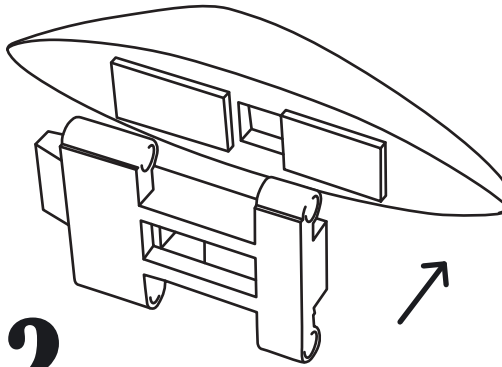

2 Wing mount

The mount for the upper and lower wing can be attached at this stage or done later.

We advise to test fit both wings and if needed drill out the holes for the mecanism. Find a suitable brass rod or similar as pin for the hinge joint.
See No.16 for futher info

NOTE:

Sand all the square holes so they fit nicely around the square ALU armature rod.

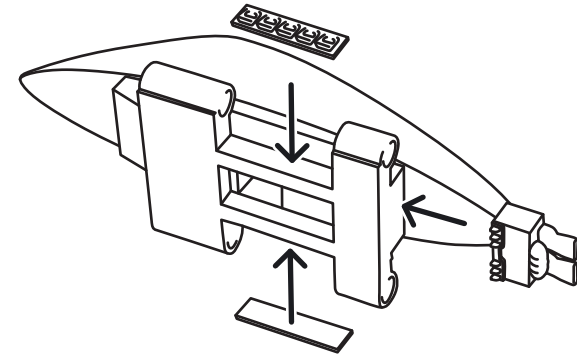
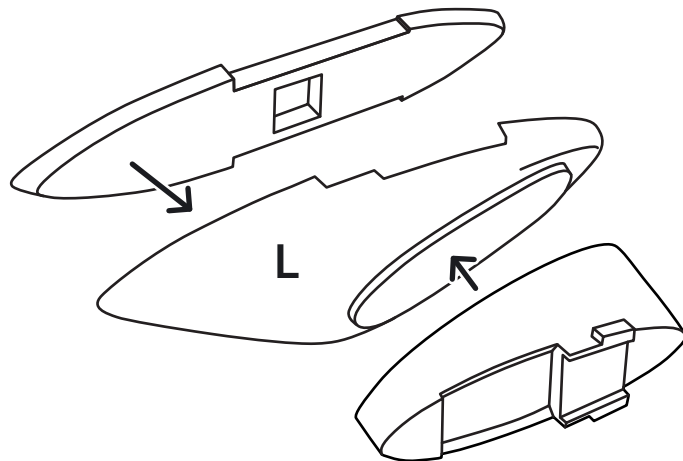

The detailing can be added later, though it might be easier to do now.

3 OPTIONAL

Attach the left POD and smaller wing to the Fuel Tanks.

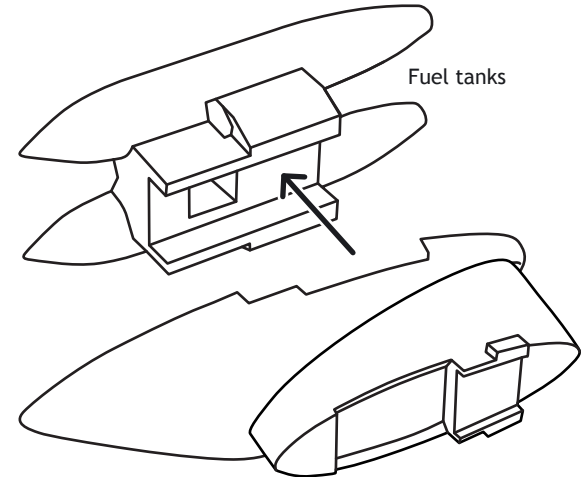

NOTE:

This can be done later and might be adviseable to wait. But try test fitting now and a feel how they go together.

4 Engine Fuselage

Important note:

The mounting point of the entire ship is inside the engine fuselage. Plan your mounting at this stage, before you glue the two engine half together.

If you want to light the 4 engine bells, study the "Engine Section" on the next page.

TEST FIT!

Assembly the upper and lower engine fuselage halves. Putty seams.

DO NOT GLUE TO ALU ROD!

Just let the engine assembly slide along the Aluminum Rod!

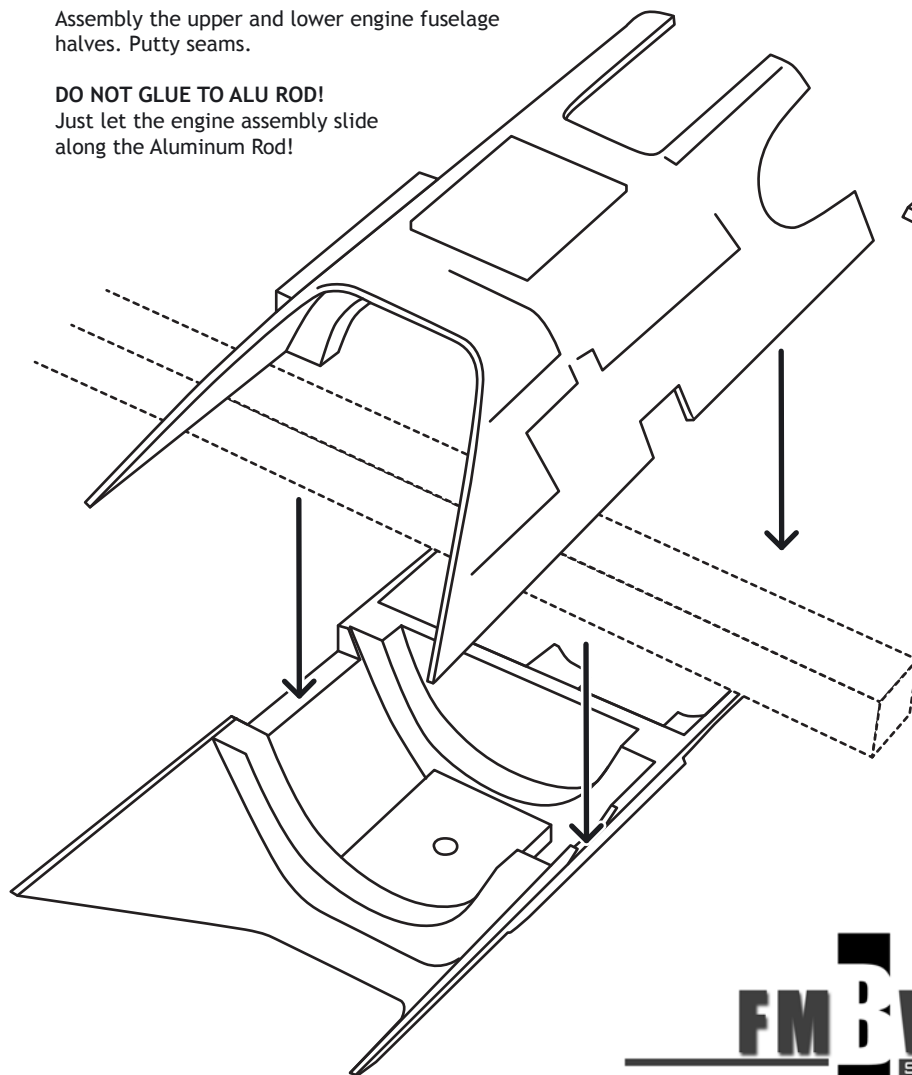

5

Slide the air intake into position and glue. Consider painting interior parts before assembly!

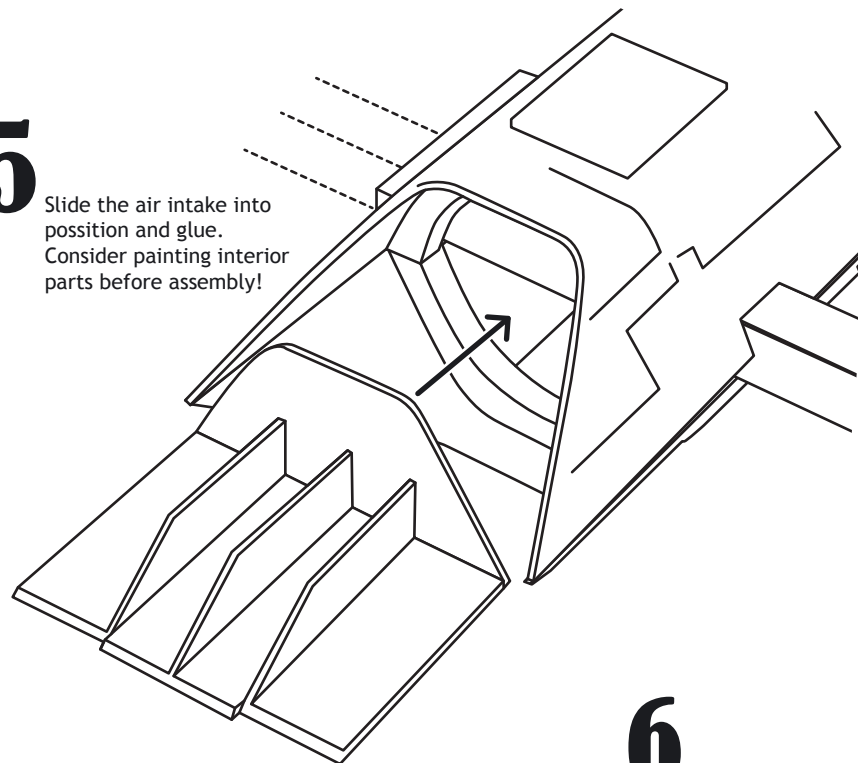

6

Slide the two air intake plates into position and glue. Sand the edges at both sides if needed, so they are 100% straight.

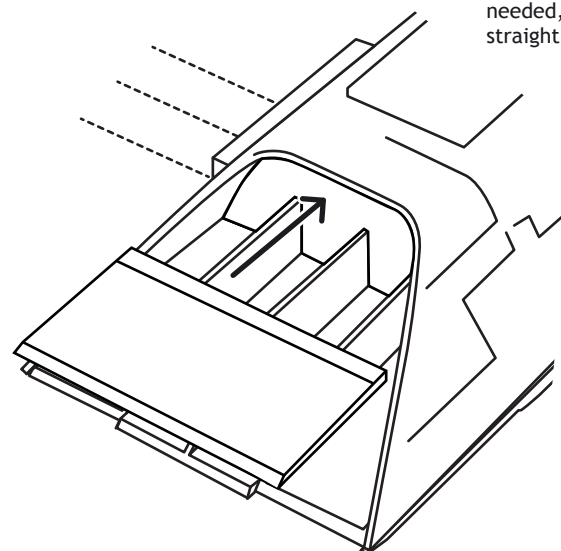

7

Engine Section

The engine section is a tricky area to build and we strongly advise test fitting before any glue is used.

We advise painting the engine interior before assembly.

Slide the thruster back plate in and glue. Additional tubing or wiring can be added as customizing. The originals do not have a such so we have taken some creative liberties to ease attachment of the engine bells.

We advise painting the engine bells before assembly.

The process can be made at a later stage in the build.

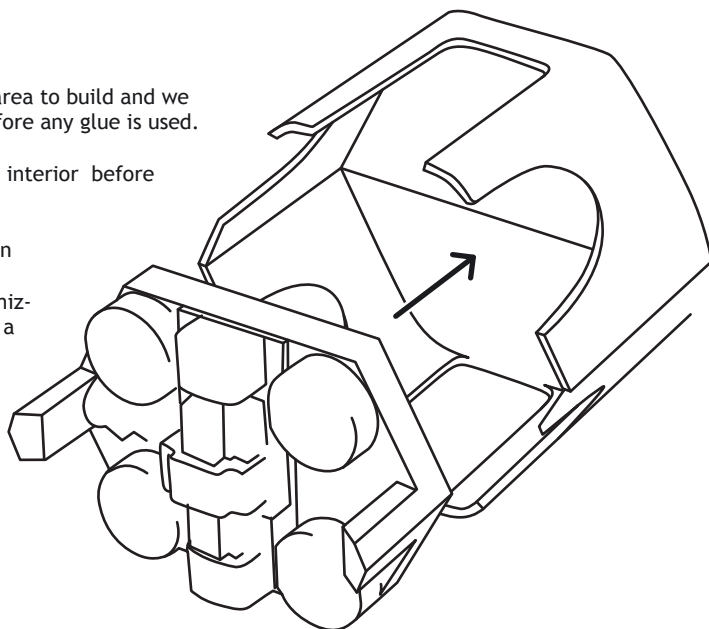

8

Glue the rear end engines to the bells.

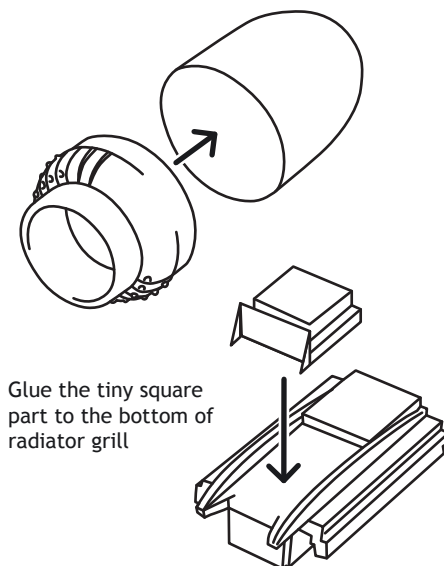
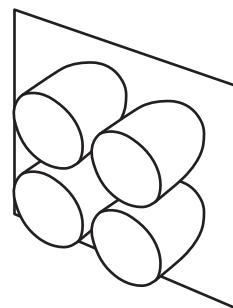

NOTE:
It's critical to get the back of the 4 bells leveled so we advise you to lightly glue them onto a piece of styrene and sand all 4 at the same time

10

Slide the bells one by one into position and glue. We advise to test fit before any glue is used.

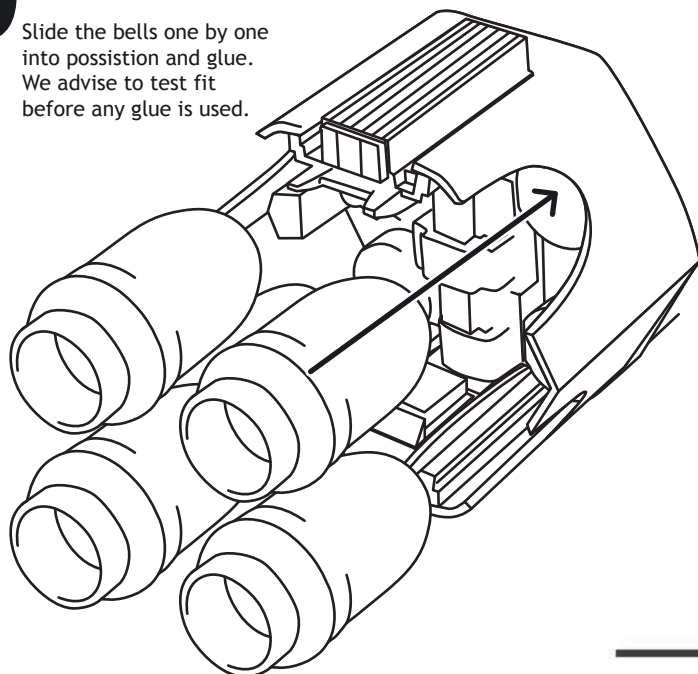

9

Slide the engine radiator grills in and glue

Do not try to add these before the back plate, the plate WILL NOT be inserted afterworth.

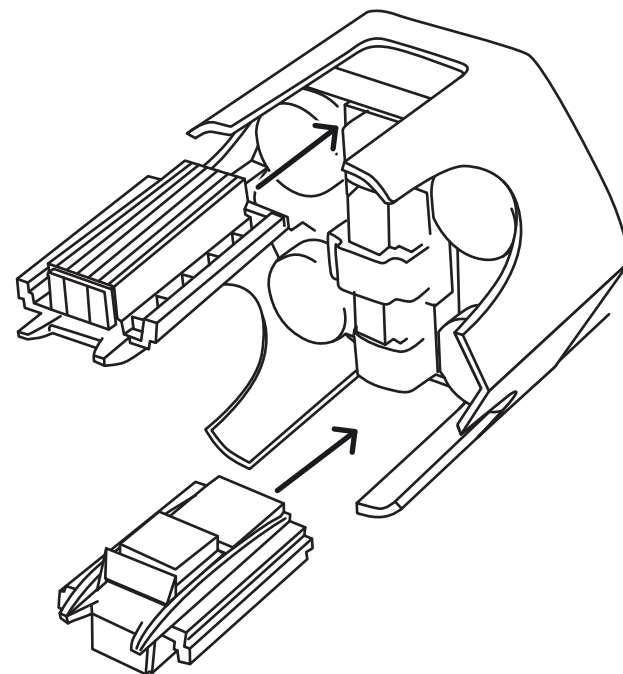

11

Main Wing

We strongly advise you to test fit all the parts needed for the main wing assembly before any glue is used.

It's important that you get a good foundation internal so the wing won't sag. Additional putty or styrene can be used for that purpose.

This part is critical, so take your time and test fit often.

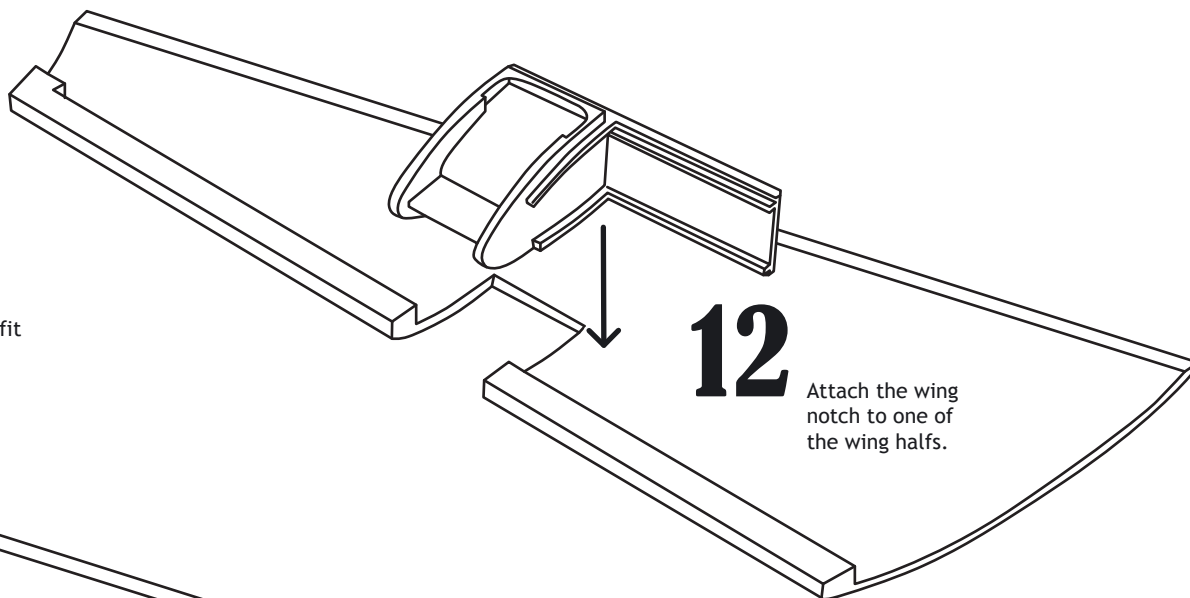

12

Attach the wing notch to one of the wing halves.

13

Glue the ALU rod.

The right POD can be used to guide the alu rod. Just slide it into position.

DO NOT GLUE!

Instead, just tape it steady to the wing part

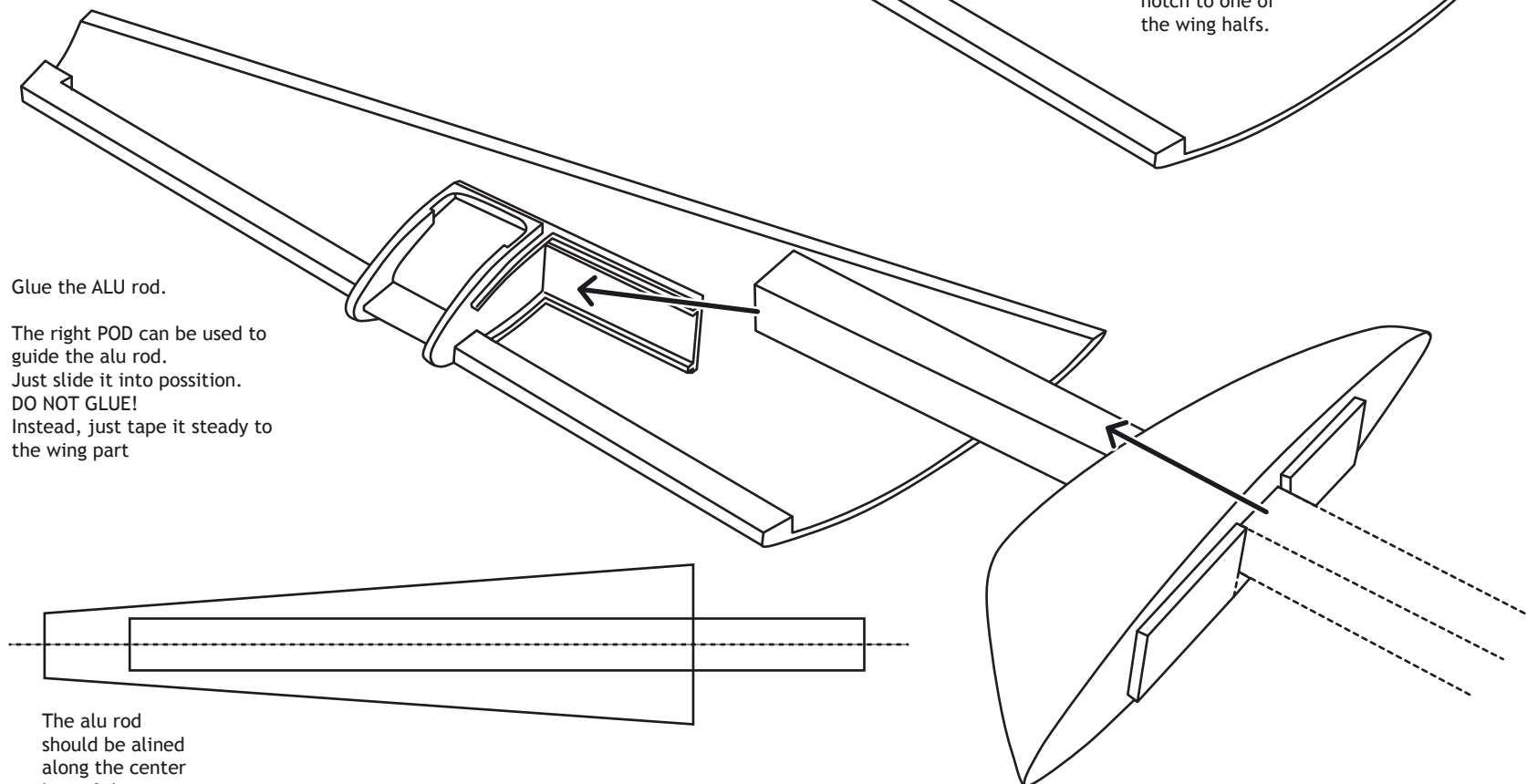

The alu rod should be aligned along the center line of the main wing.

14

A
Attach the gun holster to the end of the main wing. Pay attention while positioning additional use the other half of main wing as guide.

B
Glue the front parts to wing.

C
Attach the other half of main wing. Putty and sand all seams to get a nice curvature.

D
Slide in the right POD and glue to main wing.

The Blue B has a panel removed on the wing. We have not made that as an option, but it can be made.

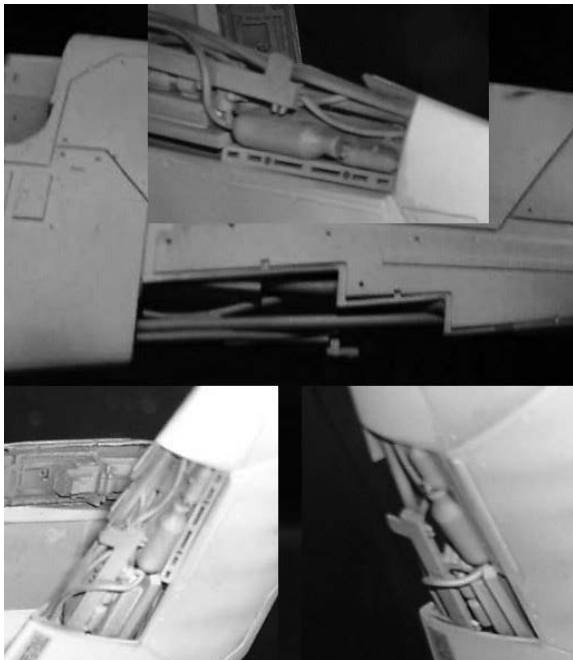

15

Slide the right POD into place and glue it to the main wing assembly.

If you haven't made No2 already it's time for that. Please look at No2

16

Wing Mount

If you haven't already attached the wing mount, do it now. Refer to No. 1 for instruction

TEST FIT!

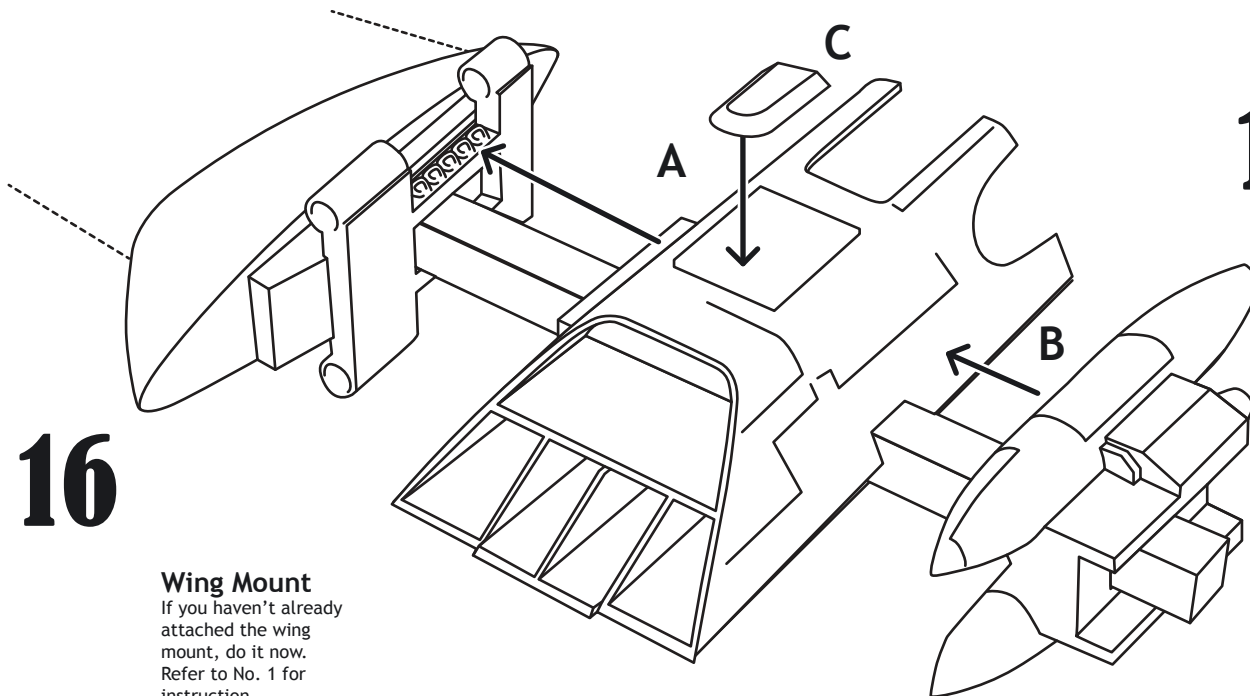

17

Engine.

A - Slide in the engine section and glue it onto the wing mount.

TEST FIT before use of glue!!

B - Slide the Fuel Tanks part onto engine. Again, test fit before use of glue.

C - Attach the top vent on the top and bottom half of engine.

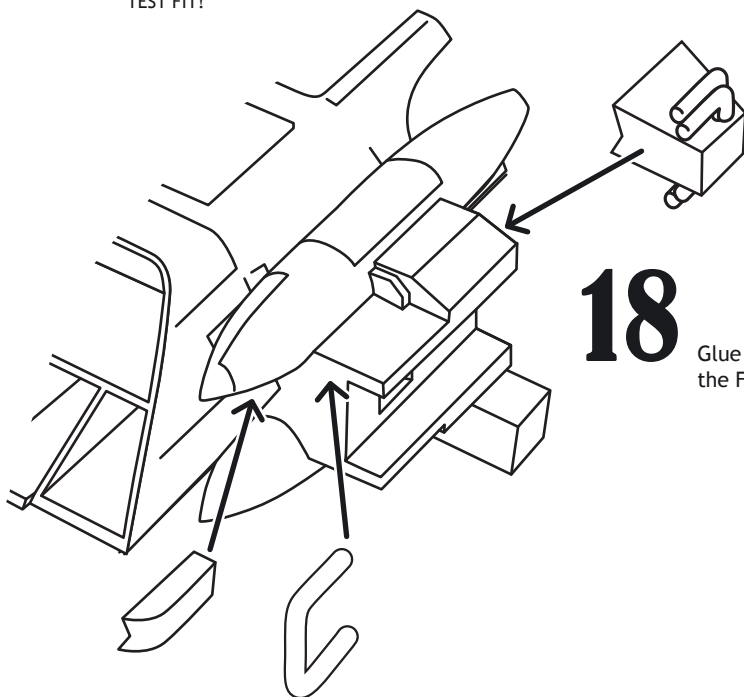

18

Glue the details to the Fuel Tanks part

19

Slide in the smaller wing assembly and glue

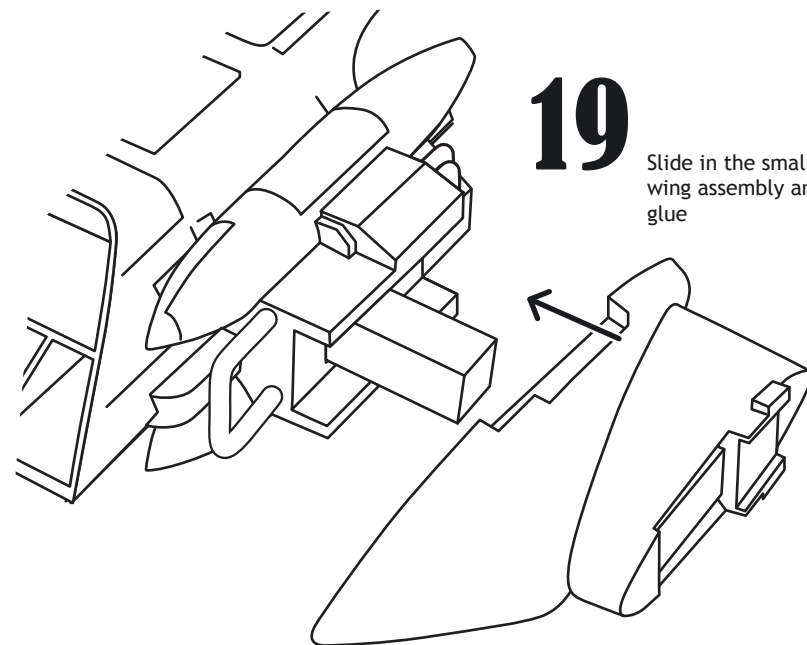

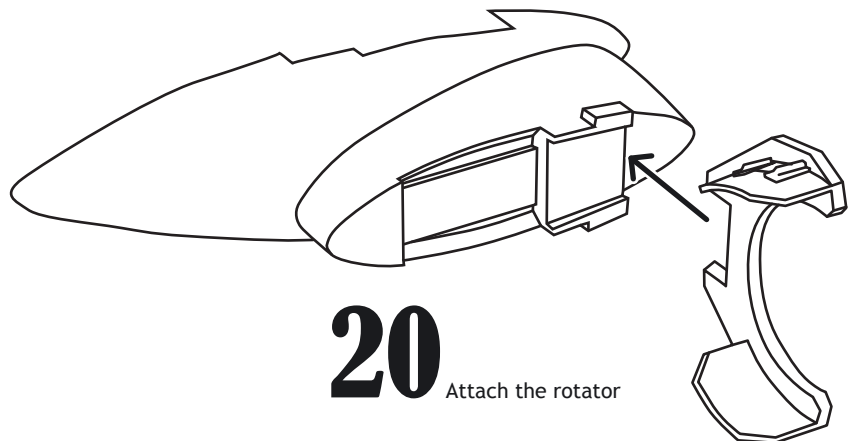

20

Attach the rotator

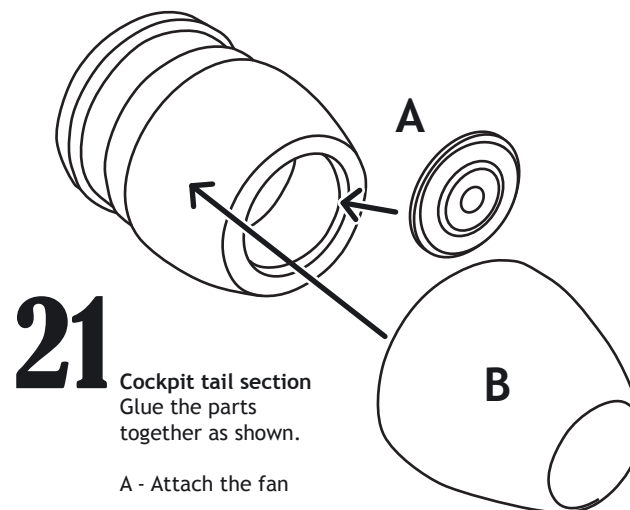

21

Cockpit tail section
Glue the parts
together as shown.

A - Attach the fan

B - Attach the outer cone.
Additional styrene can be
needed to add between the
inner and outer cones.

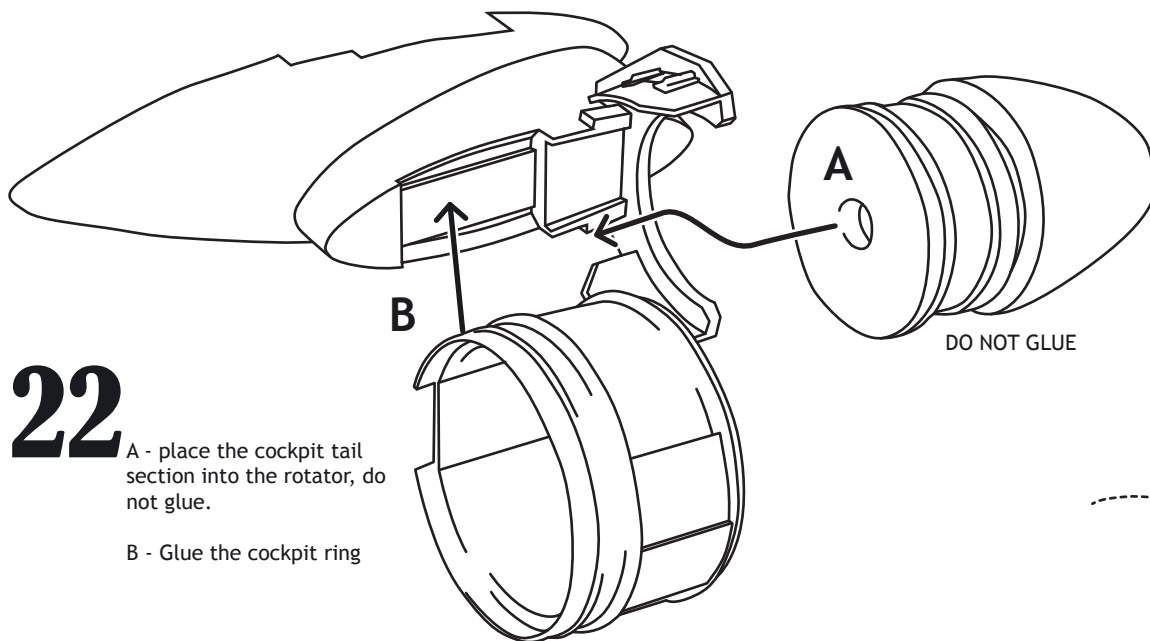

22

A - place the cockpit tail
section into the rotator, do
not glue.

B - Glue the cockpit ring

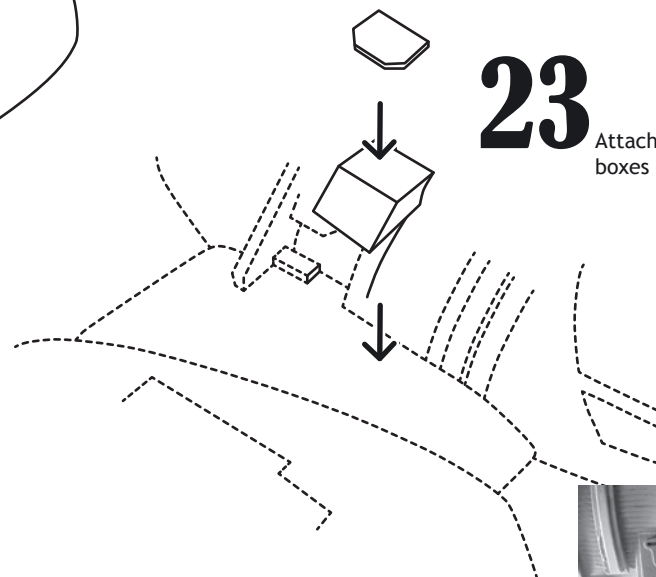

23

Attach the battery
boxes on both sides



24

Cockpit interior

The interior is tricky to make, so take you time while building it. Many parts needs paint before assembly, so test fit often and check the reference pages mentioned in the intro letter.

A - Attach the pilot seat

B - Attach the pilot. He might require sanding for a nice fit into seat.

24A - Slide in sidewalls and backwall.

24B - Attach front panel and sidepanels.

24C - Attach control sticks.

Additional wires can be added as shown on picture.

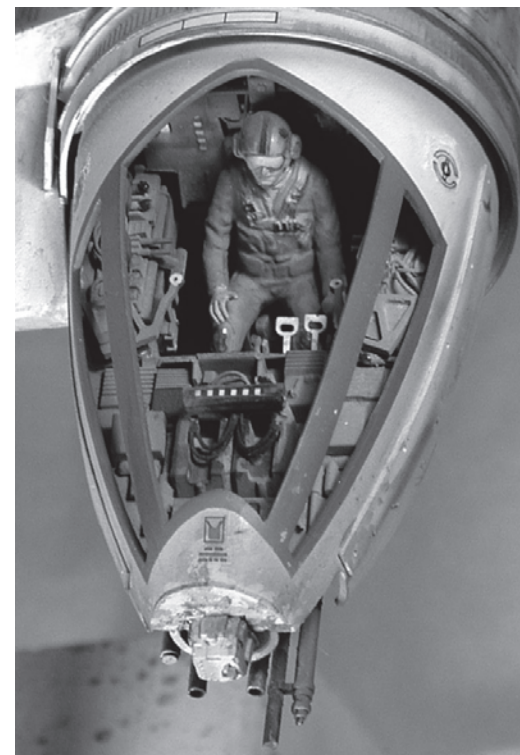
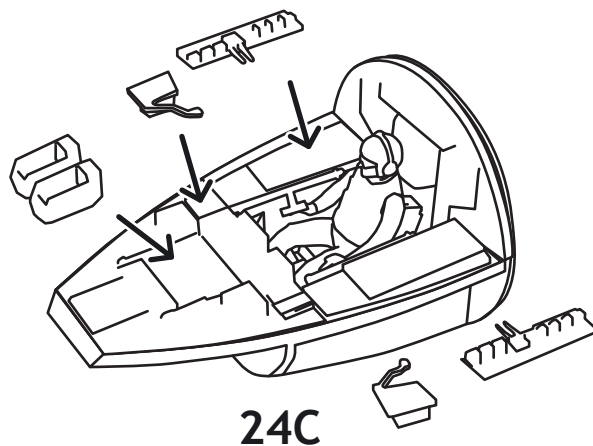
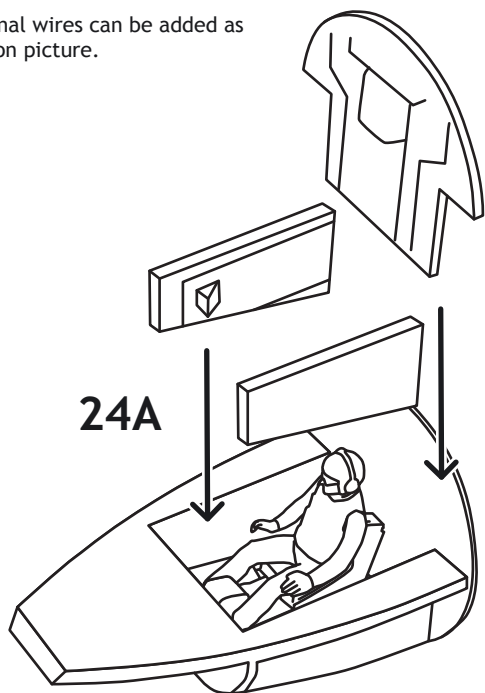
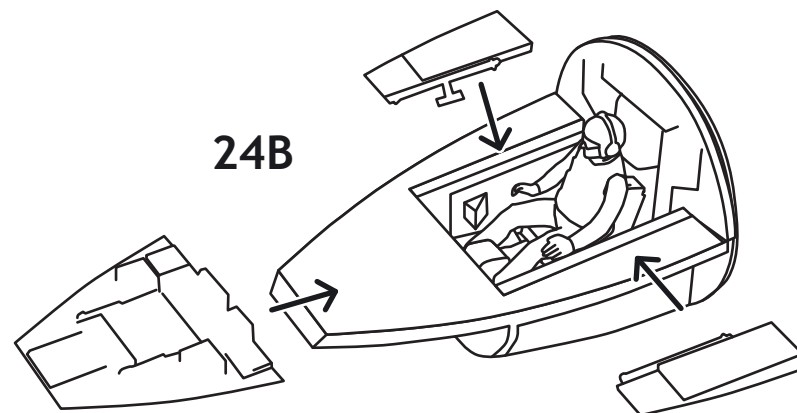
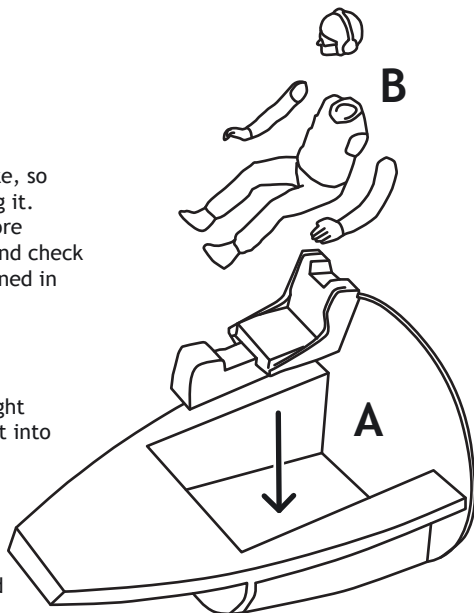

25

Cockpit guns

A - Attach the gun base.

B - Attach the main 2 barrel gun

C - Attach the smaller 2 barrel gun

D - Attach the gun cover

Paint the parts before assembly.

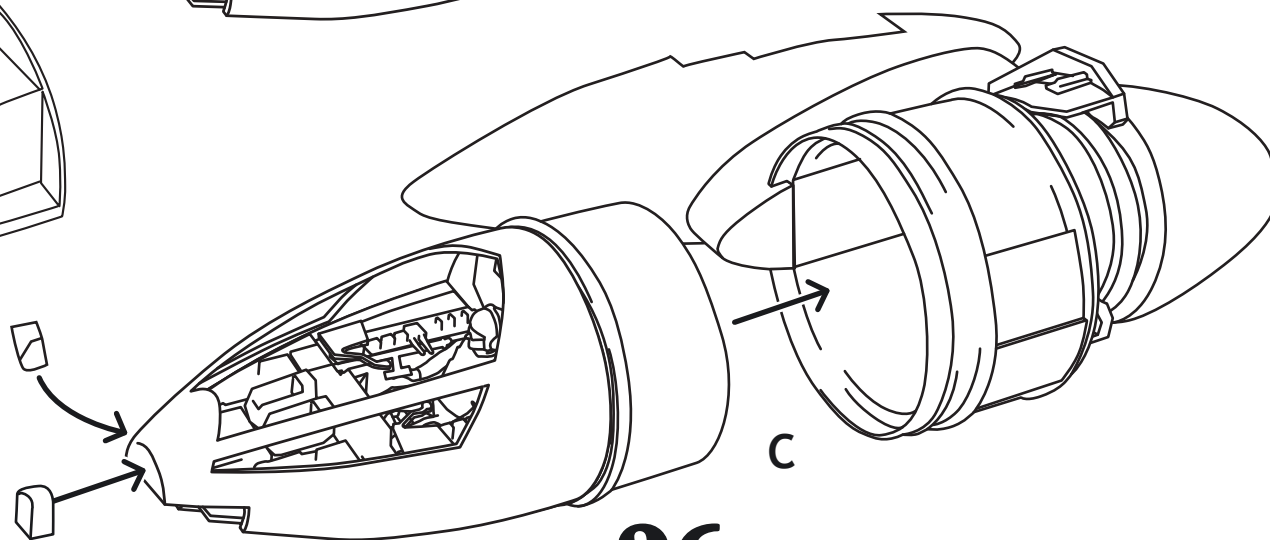
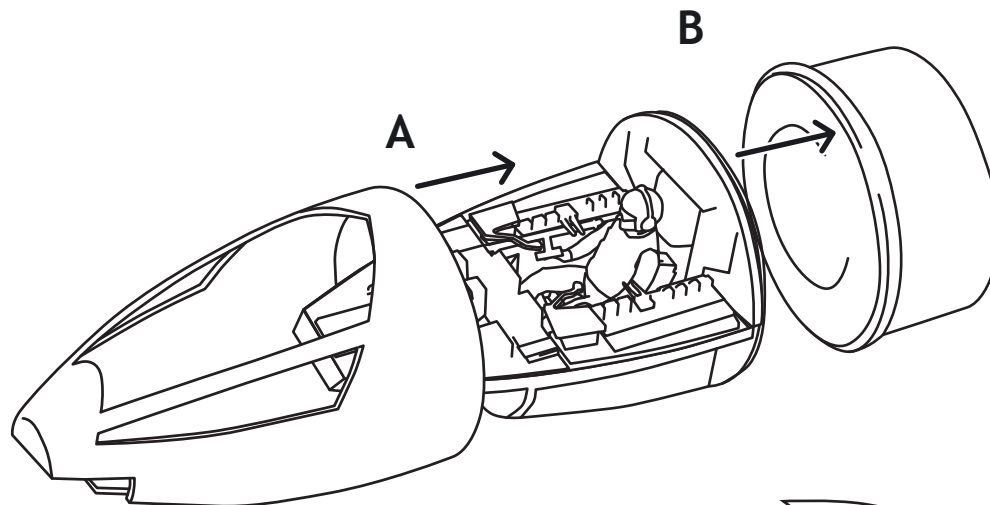
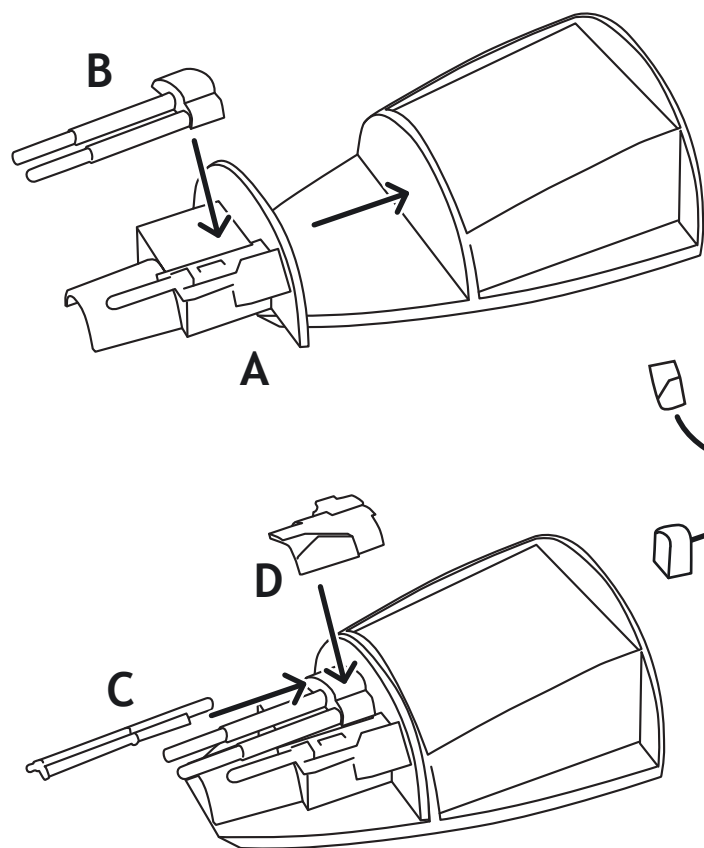

26

Cockpit Assembly

A - Slide the outer cockpit onto the interior, do not glue before it sits straight on. Might need sanding for a nice fit.

B - Attach cockpit assembly to the rotator ring.

C - Glue the whole cockpit assembly to the rear rotator. DO NOT glue it to the outer ring, but make sure the cockpit can rotate. Attach the frontend part and the tiny square at the side.

27

Main Guns

The main guns are tricky to build. We advise to test fit all parts before any glue is used. Paint the parts before assembly. Some adjustments will be needed too.

A - Glue the two pods together
B - Assembly the barrels, putty and sand.

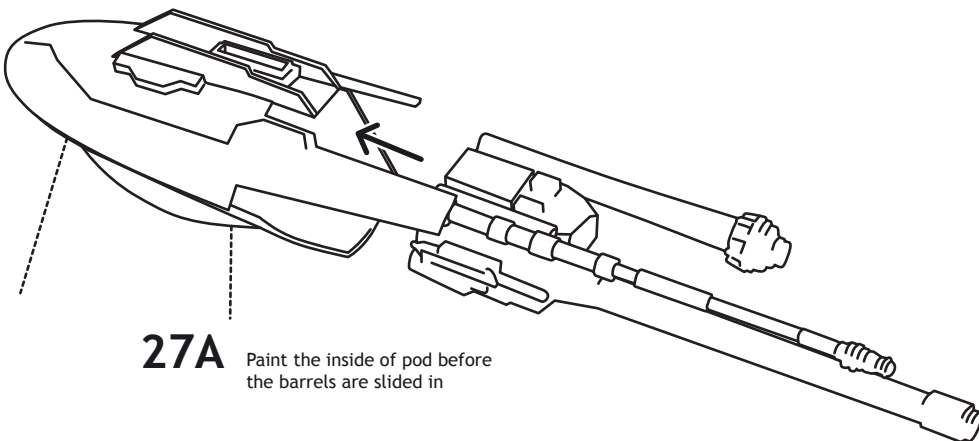
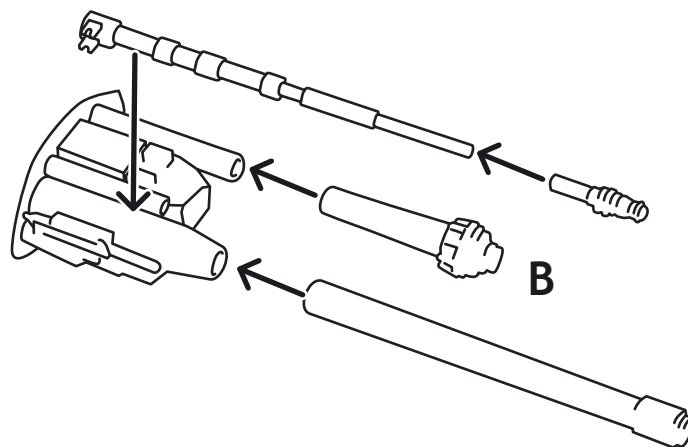
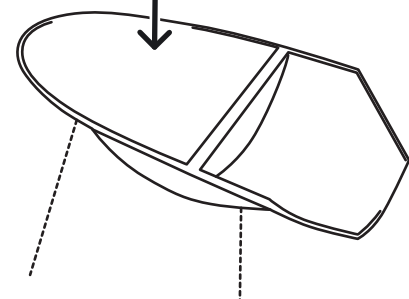
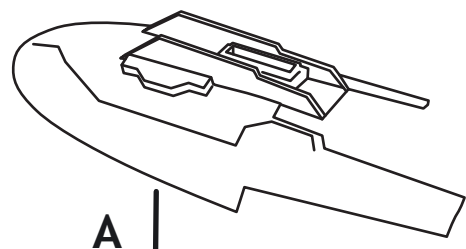

27A Paint the inside of pod before the barrels are slid in

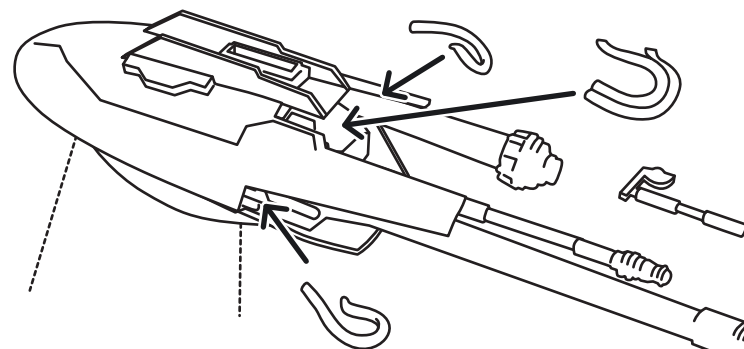

27B Attach the greeblies, some sanding is required to make a nice fit. Check reference for placement

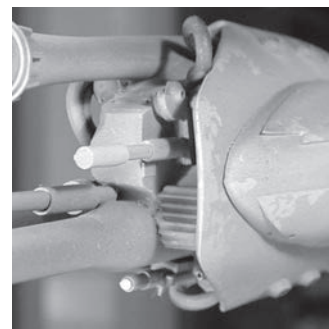
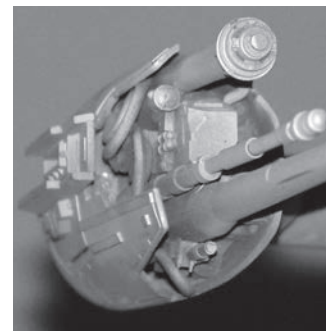
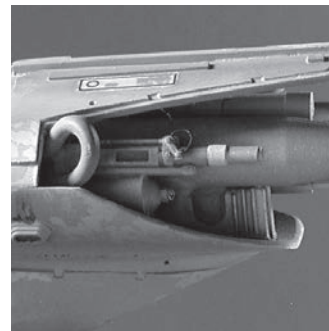

28

Wing Guns

The upper and lower wing guns are tricky too. They can be made in two configurations, blue and orange B-wing. Study the reference closely.

- A - Glue the gun base into wing pod
- B - Glue the pods to each wing
- C - Assembly the barrels, putty and sand.

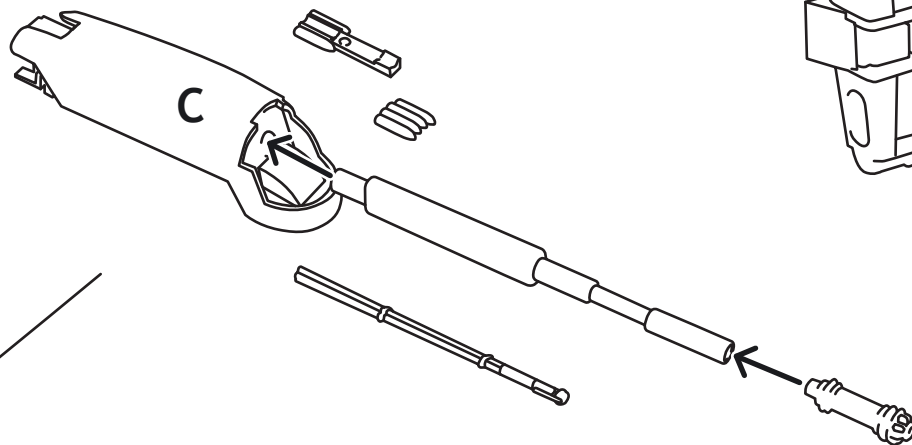
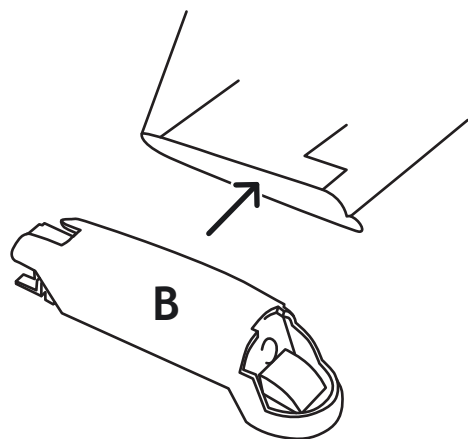
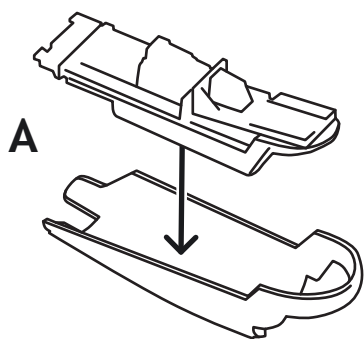
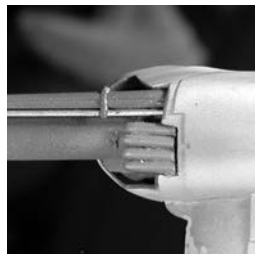
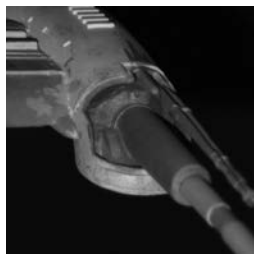
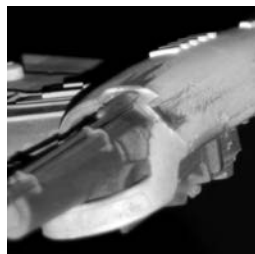

29

Upper and Lower Wings

Attach both wings to the wing mount.

Slide in a brass rod or similar to make the wing moveable. Attach the front cover. Additional lights can be made to the front cover.

